

LEGEND

- RESIDENTIAL
- GOLF COURSE
- GOLF COURSE MAINTENANCE FACILITY
- GOLF COURSE CLUBHOUSE
- EMERGENCY MEDICAL/FIRE STATION
- OFFICE/RETAIL COMMERCIAL
- COMMERCIAL/HOTEL
- CANAL
- LAKE
- WETLAND (CONSERVATION AREAS)
- PARK
- INTERSECTION WITH TURN LANES AND SIGNALIZATION
- RIGHT IN AND RIGHT OUT
- RIGHT IN AND RIGHT OUT AND SOUTH BOUND LEFT
- RESIDENTIAL ACCESS ONLY
- SECURITY GATEHOUSE

LEGEND

NORTHEAST AND SOUTHEAST QUADRANTS (COLLIER COUNTY)

	UNITS/S.E.	ACRES
*RESIDENTIAL	1311 UNITS	332.06±
OFFICE/RETAIL COMMERCIAL	1,203,091 S.F.G.L.A.	70.40±
GOLF COURSE/RECREATION/PARK/RIGHT-OF-WAY	54 HOLES	614.31±
LAKE & WATER MANAGEMENT		225.41±
CONSERVATION		5.32±
SUBTOTAL		1247.50±

NORTHWEST QUADRANT (CITY OF NAPLES)

	UNITS/S.E.	ACRES
*RESIDENTIAL	464 UNITS	100.71±
OFFICE/RETAIL COMMERCIAL	100,000 S.F.G.L.A.	14.40±
GOLF COURSE/RECREATION/RIGHT-OF-WAY	18 HOLES	107.40±
LAKE & WATER MANAGEMENT		70.04±
CONSERVATION		55.34±
SUBTOTAL		353.89±
TOTAL		1601.39±

GENERAL NOTES

- 1) WETLAND PRESERVATION AREAS ARE APPROXIMATE AND WILL BE REFINED DURING THE PERMITTING PROCESS.
 - 2) ALL ACREAGES ARE APPROXIMATE AND SUBJECT TO CHANGE AND/OR VARIATION.
- *THE DEVELOPER MAY RELOCATE UP TO 200 MULTI-FAMILY UNITS FROM THE NORTHWEST QUADRANT TO THE NORTHEAST QUADRANT SO LONG AS THE TOTAL NUMBER OF RESIDENTIAL UNITS IN GREY OAKS DOES NOT EXCEED 1775 UNITS.

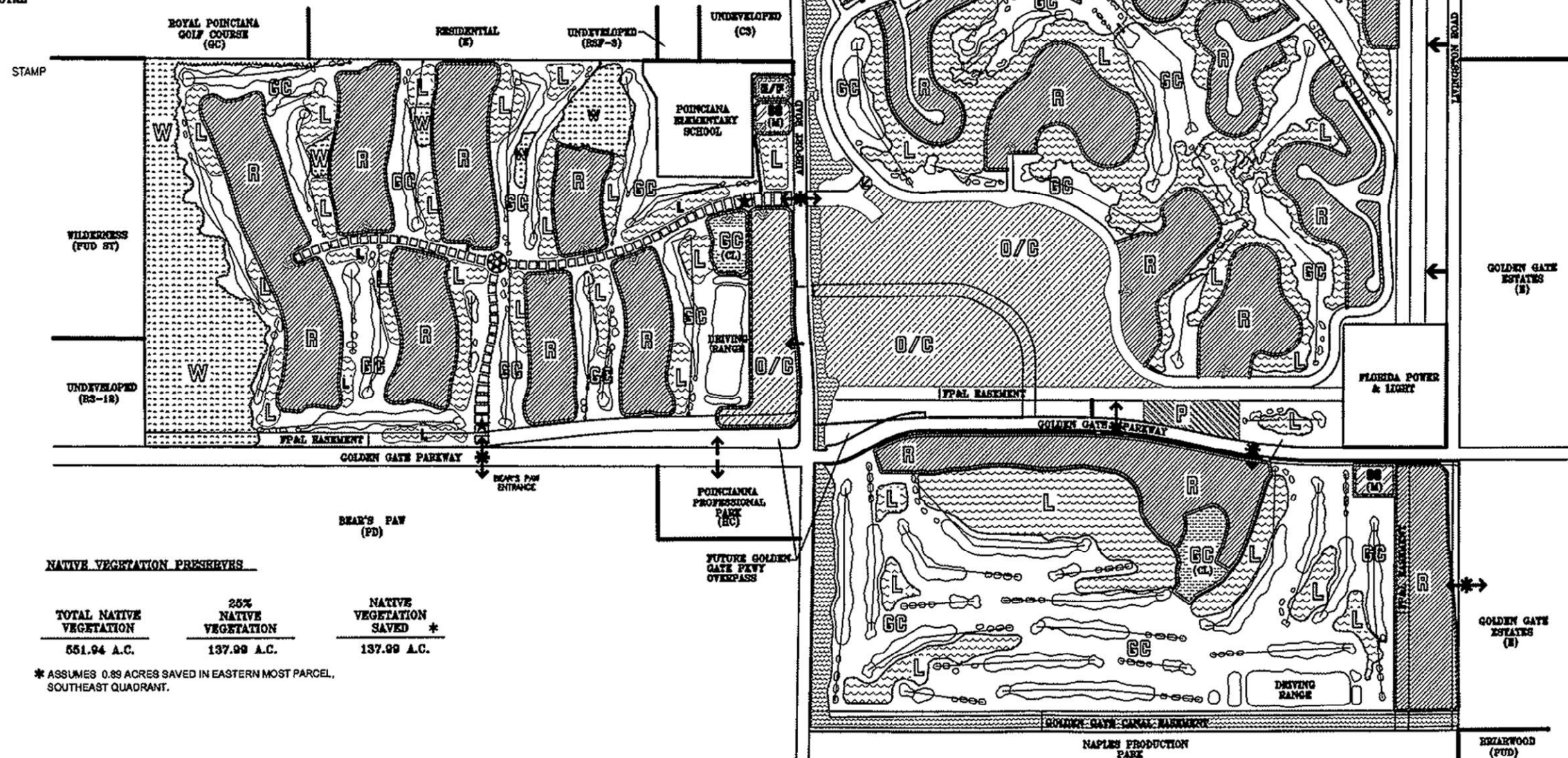

NATIVE VEGETATION PRESERVES

TOTAL NATIVE VEGETATION	25% NATIVE VEGETATION	NATIVE VEGETATION SAVED *
551.94 A.C.	137.99 A.C.	137.99 A.C.

* ASSUMES 0.89 ACRES SAVED IN EASTERN MOST PARCEL, SOUTHEAST QUADRANT.

